

# USE & CARE GUIDE

Water Dispenser  
MODEL: MIR311D-3



**Corporate Headquarters**

222 E. Campus View Blvd | Columbus, Ohio 43235

800.646.2747 | 614.861.1350

[oasiscoolers.com](http://oasiscoolers.com) | [oasis-parts.com](http://oasis-parts.com)

OASIS is a registered trademark of LVD Acquisition, LLC dba Oasis International © 2012



[oasiscoolers.com](http://oasiscoolers.com) | [oasis-parts.com](http://oasis-parts.com)



## IMPORTANT SAFETY INSTRUCTIONS

**When using electrical appliances, basic safety precautions should be followed to reduce the risk of fire, electric shock, and injury to persons or property. Read all instructions before using any appliance.**

1. Do not let hot water touch bare skin. Keep combustible material such as furniture, bedding, pillows, clothes, and/or papers away from the back of the unit.
2. Do not operate this, or any other appliance, with a damaged power cord. No other appliance should be plugged into the same outlet. Be sure that the plug is fully inserted into the outlet.
3. Do not run the power cord over carpeting or other heat insulators. Do not cover the cord. Keep cord away from high traffic areas, and do not submerge in water.
4. We do not recommend the use of extension cord as it may overheat and cause a risk of fire.
5. Exercise caution and use reasonable supervision when the appliance is used by or near children.
6. Do not use your water dispenser outdoors. Place the water dispenser away from direct sunlight and make sure that there is at least 4 inches (10cm) of space between the back of your unit and wall. Keep a minimum of 2 inches (5cm) on each side of your unit free.
7. Do not use this product to dispense anything other than water.
8. To avoid a hazard due to instability of the appliance, it must be placed on even and flat surface.
9. If the supply cord is damaged, the manufacturer or its service agent or a similarly qualified person must replace it in order to avoid a hazard.
10. This water cooler must be positioned so that the plug is accessible.
11. Disconnect the plug from the outlet when not in use.
12. Remove power plug or disconnect from the main power source before servicing the appliance.

## TECHNICAL SPECIFICATIONS

MODEL	:MIR311D-3
RATED VOLTAGE	:115V~60Hz
HEATING POWER	:500 W
COOLING POWER/CURRENT	:85W/0.8A
HOT WATER	≥90°C 5L/h
COLD WATER	≤10°C 2L/h
ENVIRONMENTAL TEMP.	:ST
COOLANT	:R134a, 35g
RELATIVE HUMIDITY	≤90%
PROTECTION OF ANTI-ELECTRIC-SHOCK	:I

## PRODUCT DIAGRAM

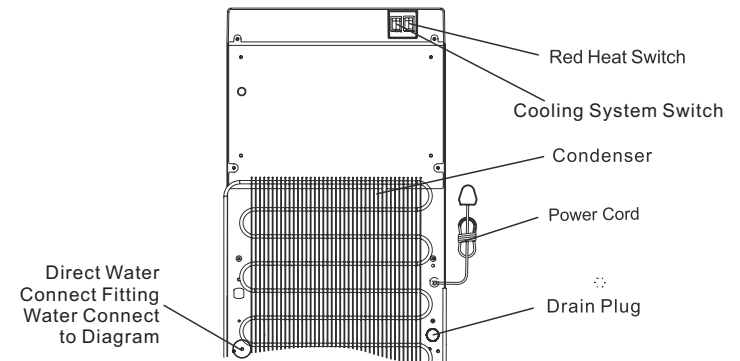
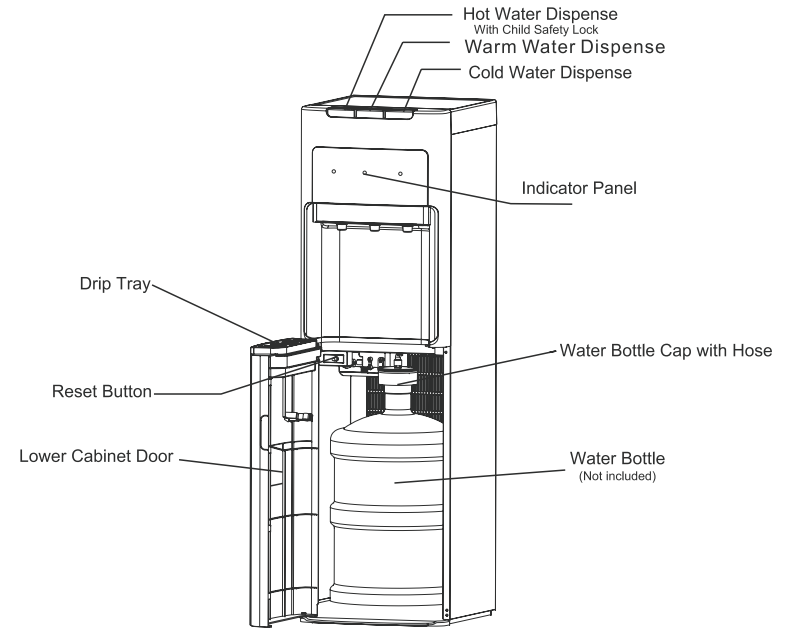

## UNPACKING THE WATER COOLER

1. Cut and remove the straps from the box. DO NOT turn the box upside down, or lay it on its side. The bottom of the box is separate from the top section. Lift straight up on the top box section to remove the top box section. Remove the Styrofoam packaging and plastic bag. Lift the water cooler off the bottom of the box. Wipe it clean if necessary.
2. Place the machine on a hard, flat surface. Make certain the unit is level. The unit should not be close to direct sunlight or other source of heat.
3. It is best to place the water cooler in an area with good air circulation. Make sure there is at least 4 inches (10cm) of space between the back of your water cooler and the wall. Keep a minimum distance of 2 inches (5cm) on each side of your water cooler.

**WARNING:** The drain cap on the back of the unit may become loose during shipping. Fasten the drain cap tightly before you start to operate the unit. If the drain cap is loose, the unit may leak and cause floor damage.

## PREPARING THE WATER COOLER FOR USE

This model is different from a traditional water cooler. The water bottle does not need to be placed upside down on the top of the unit. The water bottle is placed in the lower cabinet of the unit, and then a pump draws the water up to the dispenser.

**Much like a new refrigerator with an ice maker or water dispenser, it is recommended to run 1 or 2 water bottles full of water through the system before use.**



1. Make sure the water dispenser is not plugged into an electrical outlet.
2. Open the door of the lower cabinet.
3. Place full water bottle on floor. Remove the plastic cover over the mouth of the water bottle.
4. Place the stainless tube inside the bottle and place the water bottle cap firmly over the mouth of the water bottle.
5. Attach the hose to the top of the cap using the quick connect system shown below.
6. Slide the bottle inside the cabinet and close the lower cabinet door.
7. Plug the water cooler into a grounded power outlet and turn on the power switch located on the back.
8. The unit will start to operate, but you should wait at least half an hour before using the water cooler.
9. This unit is equipped with red switch that turns the heating feature on and off. If you are not going to use hot water, turn the heating switch to "OFF" to conserve energy.

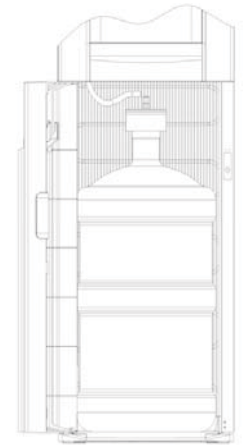

**NOTE:** If there is not a secure connection between the hose cap and the connector on the water cooler, the water pump will operate but the water cooler will not dispense water. Make sure the hose is connected to the stainless tube correctly.

**NOTE:** Please wait until the water pump stops running before using the unit. If the water tank is not full, no water will dispense from the cold water faucet and the hot water faucet.

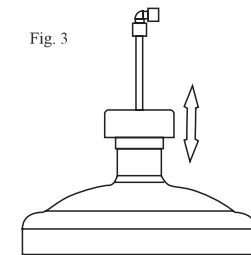
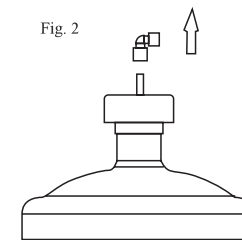
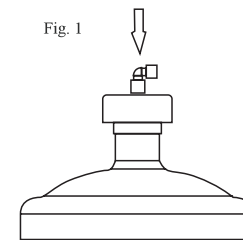

1. Your new water cooler features an adjustable quick connect system. For proper operation, make sure the connector is sealed tight (Fig. 1).
2. The connector can be removed easily for cleaning with warm soapy water (Fig. 2)
3. The hose cap can be adjusted up and down to accommodate both 3 gallon and 5 gallon water bottles. (Fig. 3)



## OPERATION

After the water bottle has been connected to the water cooler the unit is ready for use. Turn the Heat and cooling switch on the back of the unit to ON. The water cooler will start running. First the unit will pump the water from the water bottle into the cooling and heating tanks, and then the unit's compressor and heater will start to operate. The first time the water cooler is used, you will have to wait at least half an hour for hot and cold water.

The Aqua Sub water cooler has 3 indicator lights on the front panel.

- When the  indicator light is Blue, the unit is in the process of cooling water. When cooling process is complete, the indicator light will turn off.
- When the  indicator light is Red, the unit is in the process of Heating the water. The Red light may turn off for 30 seconds, during pump operation. This is a normal safety feature. When the heating process
- When the  indicator light on the front panel is on, there is no water left in the water bottle. The water bottle will need to be replaced. Replace the water bottle, and close the door to reset the unit. The water cooler will work again and the indicator light will turn off.

### Using the Water Cooler

- To dispense HOT water, slide the Hot Water Handle to the left side and then press the button all the way in.
- To dispense ROOM TEMP water, press the center button.
- To dispense COLD water, press the cold water button all the way in.

## CLEANING & MAINTENANCE

1. To avoid accidents, turn off and unplug the water cooler from the outlet before cleaning.
2. A soft damp cloth may be used to clean the surface of the water cooler. When necessary, a mild detergent may be used. DO NOT use erosive chemical solvents to clean the unit, as this may damage the surface of the water cooler.
3. DO NOT pour water on the exterior of the unit to avoid getting the internal electrical system damp. DO NOT immerse the unit in water when cleaning.
4. The water bottle cap, hose, and drip tray may be washed in a dishwasher (**top rack only**).
5. Keep the water cooler 4 inches (10cm) away from the wall so it can work properly. Make certain all ventilation openings are clear of obstruction.
6. Do not damage the heating or cooling system, paying particular attention to the black condenser or heat radiator on the back of the water cooler.
7. If you will not use the water cooler for a long period of time, please unplug the power cord and drain the water cooler. Drain the water from all faucets, then remove the drain cap on back and allow it to drain. Make certain the drain cap is fastened tightly when finished.

## TROUBLESHOOTING

Please check the troubleshooting chart below. It includes several common problems, which you can correct at home, making a customer service call unnecessary.

Problem	Possible Cause	Remedy
Unit does not dispense hot and cold water.	Unit is unplugged.	Plug the power cord into an outlet.
	Main power supply is off.	Reestablish main power supply.
	Damaged water dispenser	Replace the dispenser.
	The water bottle cap is not attached properly to the connector on the water cooler.	Connect properly. There will be a give when the hose cap slides properly over the connector.
Unit does not dispense cold water.	Over consumption of cold water in a short time.	Wait a moment for the water to cool.
	System Malfunction	Contact OASIS International for service
	The ventilation around the unit is insufficient.	Space the unit from the wall by more than 15 cm.
Unit does not dispense hot water.	The temperature of water in the water bottle is too high. (When the bottle is exposed to direct sunlight for a long time.)	Place the water bottle in a cool location out of direct sunlight.
	Over consumption of hot water in a short time.	Wait a moment for the water to heat.
Unit is noisy during operation.	System Malfunctions	Contact Oasis International for service
	The appliance is not level.	Place the unit on a level, flat surface.
Water leaks from the faucet.	Unit is touching other objects.	Move the unit away from other objects.
	The top portion of the faucet has become loose.	Tighten the top threaded portion of the faucet.
Water is dripping out of the water cooler and onto the floor.	The faucet has been damaged.	Call the customer service telephone number to repair the faucet.
	The Hose Connector is not connected properly or the inside hot or water tanks are leaking.	Make sure the hose connector is properly connected. Contact Soleus Air Service if a water tank is leaking.
The water being dispensed has a strange taste.	The drain cap on the back is not fastened properly.	Tighten the drain cap. If the sealing silicon material inside the drain cap is torn or damaged, then replace with a new one.
	This is not uncommon with new water coolers. Do not worry, this is not dangerous to your health. This water cooler is FDA approved.	Clean the hose in the dishwasher (top rack only) or let it soak in dish soap. The strange taste usually goes away after the first bottle has been used up.

### CONVERTING TO DIRECT WATER LINE (bottle-less water option)

Your cooler comes ready to use a 3-gallon (11.4 L) to 5-gallon (18.9 L) water bottle, or it can be used with a direct water line connection and filtration system. If the inlet water pressure is above 100 psi, a pressure regulator must be installed in front of the unit's water inlet.

1. Remove the bottle siphon from the door by pulling the handle away from the door. (See arrow in Fig. A)
2. Disconnect the (1) Bottle Siphon tube (1/4") and (2) Return tube (3/8") from the Bottle Siphon assembly quick-connect fittings. (See Fig. A)
3. Join both tubes together with the supplied quick-connect fitting. (See Fig. B)
4. Store the siphon in a safe place for future use. The siphon assembly fits in the open space next to the condenser.
5. At the rear of the unit, locate the water connection fitting with a coil of tubing next to the condenser. When using a Filter system, disconnect the Elbow (In-line) fitting at the mid length of the tube, and store for future use with the Bottled water feature. (Fig. C)

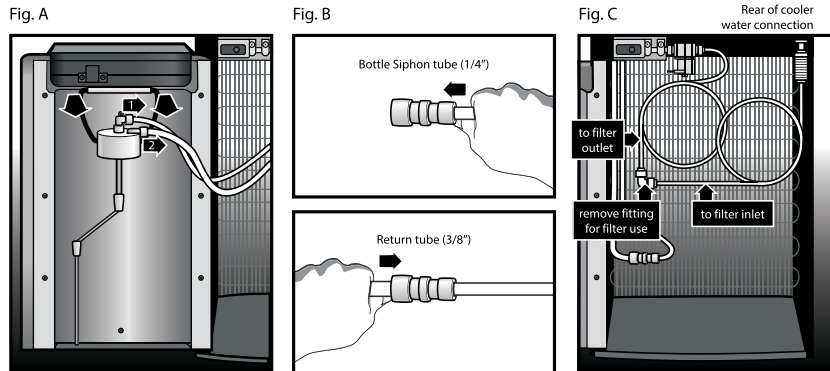

### WATER TUBE CONNECTION/DISCONNECTION PROCEDURES

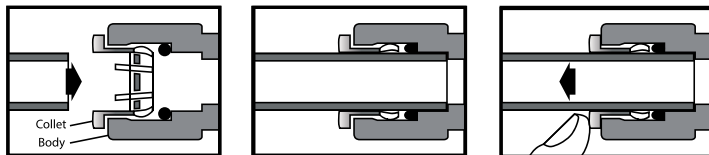

To connect, push tube through collet ring into body.

Tube must sit fully past o-ring.

To disconnect, hold collet ring against body and pull tube out.

**Note:** Do not use water that is microbiologically unsafe or of unknown quality without adequate disinfection before or after the system.

6. Assemble the filter as per individual instructions. (Fig. D)  
**NOTE: Filter set sold separately.**
7. The filter bracket has several hole patterns to accommodate different filter mounting configurations. It may be necessary to provide your own holes per your individual filter instructions.  
**NOTE: Mounting screws are not included with your cooler.**
8. Mount the filters to the filter bracket per individual instructions. (Fig. E)  
**NOTE: Follow any preflush instructions supplied with your filter set before making any connections to the water cooler.**
9. Connect the water supply tube to the inlet side of the connection fitting, at the rear of the cooler. And, connect the length of 1/4" tubing from the connection fitting (on the inside of the cooler) to your filter system. (Fig. F)
10. Connect the 1/4" tube, leading to the water valve (supplied with your cooler) to the outlet side of your filter system. (Fig. G)
11. Make your external water supply connections.  
**NOTE: Observe all local and state plumbing codes.**
12. Your cooler is equipped with an open-door interlock system that will suspend all cooler functions while the access door is open. The access door must be shut for the cooler to operate correctly. (Fig. H)  
**NOTE: Follow start-up instructions at the front of this document.**

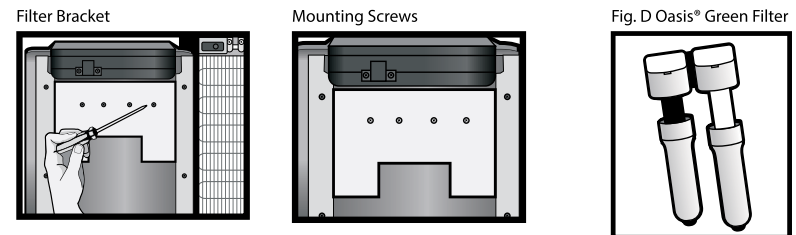

Green Filter replacement media can be purchased online at [www.oasiscoolers.com](http://www.oasiscoolers.com)

### Installation of Filters (Oasis® Green Filter shown)

