

LIQUIfit™ VAS

Angled Stop Valve



Parker's new Angle Stop Valve (VAS) design allows quick additions of connections for a filtration, reverse osmosis, coffee, or ice making unit between your existing water supply valve and supply line. By combining Parker's advanced LIQUIfit™ connection technology with proven TrueSeal™ ball valve construction, our VAS is designed for superior performance and reliability. The banjo bolt, made from a tough polyetherimide plastic, minimizes the potential for cross-threading while meeting low lead regulations.



Contact Information:

Parker Hannifin Corporation
Fluid System Connectors Division
300 Parker Dr.
Otsego, MI 49078

phone 269-692-6555
fax 269-694-4614

www.parker.com

Product Features:

- Full flow design reduces pressure drop across the valve
- Valve body rotates for easy tube routing
- Removable clip for changing the handle orientation
- 3/8" female compression x 1/2" male NPSM adapter for connecting to 1/2" IPS lines



ENGINEERING YOUR SUCCESS.

LIQUIfit™ VAS

Angled Stop Valve

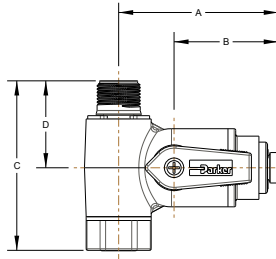
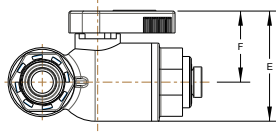

Part No.	Tube O.D.	A	B	C	D	E	F	Male Thread	Female Thread
LFPP4VAS6	1/4	1.79	1.07	2.17	1.11	1.41	.91	9/16-24 UNEF-2A	9/16-24 UNEF-2B
LFPP6VAS6	3/8	2.02	1.31	2.17	1.11	1.41	.91	9/16-24 UNEF-2B	9/16-24 UNEF-2B

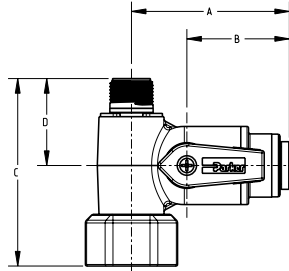
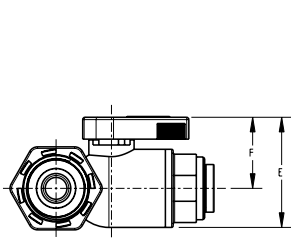

Part No.	Tube O.D.	A	B	C	D	E	F	Male Thread	Female Thread
LFPP4VAS8*	1/4	1.79	1.07	2.40	1.11	1.41	.91	9/16-24 UNEF-2A	1/2-14 NPSM
LFPP6VAS8*	3/8	2.02	1.31	2.40	1.11	1.41	.91	9/16-24 UNEF-2B	1/2-14 NPSM

* Part number includes adapter U8TVA6

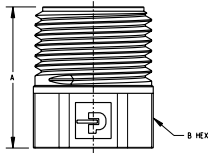

Banjo Bolt Adapter

Part No.	A	B	Thru Dia.	Male Thread	Female Thread
U8TVA6	.98	.75	.28	1/2-14 NPSM	9/16-24 UNEF-2B

1. Shut off water supply at brass/chrome supply valve.

Disconnect riser from brass/chrome supply valve.

Ensure that the sealing gasket is fully seated into the Angle Stop Valve female thread.

2. Install Angle Stop Adapter Valve on supply valve.

Connect the riser to the Angle Stop Adapter Valve.

3. Fully insert tubing into the Speedfit side of the valve.

Open valves and check for leaks.