

FILTER STRAINERS

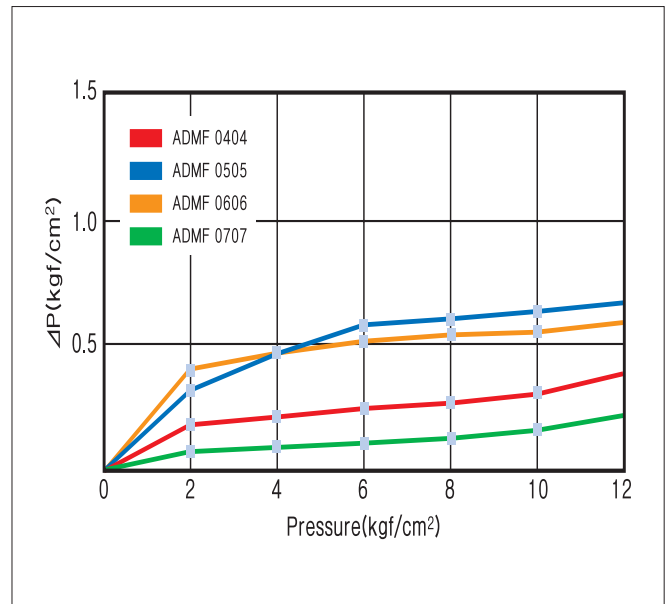

■ Features

- A rugged and durable filter strainer, available in 100 mesh (standard) with optional 150 or 200 mesh replaceable elements.
- **DMfit**®. Compatible with DMfit tube and fittings, as well as standard-sized tubing from a variety of other manufacturers.
- Color options: gray, white, or black.
- The detachable CAP and BODY allow for easy servicing and cleaning.
- Can be used with a variety of chemicals and gases. However, when using with other than water or air, please refer to the Chemical Compatibility Tables or consult with your DMT representative.
- Do not apply excessive vibration, torque, shock or other strong loads to the filter. The filter body may be damaged or collets may be dislocated.

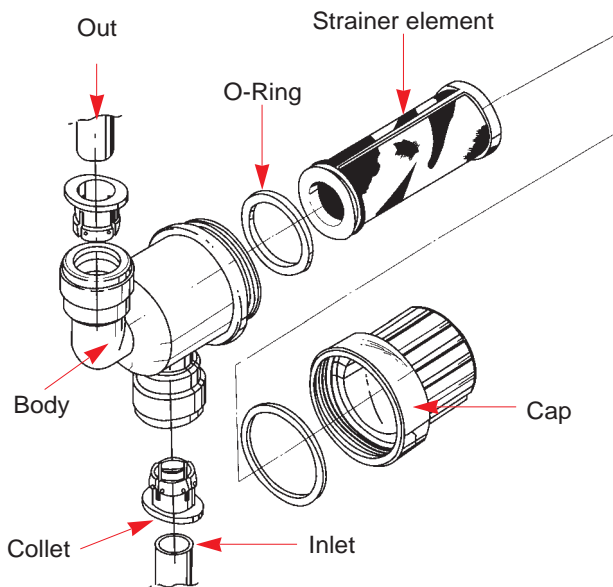

■ Working Pressure and Temperature

Parameter \ Size	1/4"	5/16"	3/8"	1/2"
	6mm	8mm	10mm	12mm
Pressure	170psi			
Temperature	Air -20°C(-4°F) ~ 65°C(150°F) Liquid			

※Maximum pressure values are based on use at room temperature.
 ※Consult your DMT representative when using at continuous elevated temperature and pressure

■ Filter Materials and Mesh Size

Screen Mesh	Standard	Special Order	
	100 Mesh	150 Mesh	200 Mesh
Materials	SUS		

※Standard models are provided with 100 mesh screen elements.
 ※150 and 200 meshes are available by special order.

■ Inch Size (Standard-100Mesh)

PART NO.	INLET	OUTLET	Qty / Box
ADMF 0404	1/4	1/4	50
ADMF 0505	5/16	5/16	50
ADMF 0606	3/8	3/8	50
ADMF 0707	1/2	1/2	40

■ Metric Size (Standard-100Mesh)

PART NO.	INLET (mm)	OUTLET (mm)	Qty / Box
ADMF 0606M	6	6	50
ADMF 0808M	8	8	50
ADMF 1010M	10	10	50
ADMF 1212M	12	12	40