



## NSF/ANSI 169-CERTIFIED Quick Connects

Nordson MEDICAL's National Sanitation Foundation (NSF)-certified components are produced from materials that comply with standards for potable water and food-safe applications. We are pleased to now offer quick connects containing certified materials, such as NSF 51 Acetal, NSF 61 Buna-N, and NSF 61 EPDM, as well as options in Polypropylene and Polysulfone.

### FEATURES & BENEFITS

- Legacy metal and advanced plastic thumb-latch couplings with hose-barb and threaded terminations
- Resistant to most mild chemicals
- Intuitive, easy-to-use design
- Audible click when coupled
- Durable panel-mount designs
- Available with internal shut-off valves or straight-through designs
- Interconnect with each other and with similar industry thumb-latch couplings

### SPECIFICATIONS

- **Materials:**
  - NSF 51 Acetal (POM)
  - NSF 61 Buna-N
  - NSF 61 EPDM
  - Food-Grade Chrome/Brass
  - Food-Grade Polypropylene
  - Food-Grade Udel® Polysulfone
  - Stainless Steel
- **Operating Pressure:**
  - Vacuum to 60 psi - 250 psi (4.2 bar - 17.3 bar)
- **Temperature:**
  - -40°F - 180°F (-40°C - 82°C)
- **Flow Capacity:**
  - 1/8" - 1/2" (3.2 mm - 12.7 mm)
- **Tubing Sizes:**
  - 1/16" - 1/2" (1.6 mm - 12.7 mm)



COMPONENT

# NSF/ANSI 169-Certified

## QUICK CONNECTS

### 20 SERIES QUICK CONNECT COUPLINGS

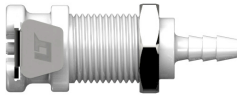

**20AC-S3-02N3**  
LinkTech 20AC Series Panel Mt. Female  
Non-Valved, 1/8" HB  
NSF 51 Acetal



**20ACV-PB2-02N3**  
LinkTech 20AC Series Straight Male  
Valved, 1/8" HB  
NSF 51 Acetal, NSF 61 Buna-N

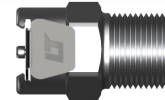

**20CBV-SB1-04N3**  
LinkTech 20CB Series Male Thread Female  
Valved, 1/4" MNPT  
Chrome Brass, NSF 61 Buna-N

### 40 SERIES QUICK CONNECT COUPLINGS

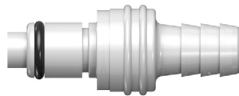

**40ACV-PB2-06N3**  
LinkTech 40AC Series Straight Male  
Valved, 3/8" HB  
NSF 51 Acetal, NSF 61 Buna-N

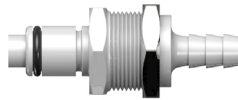

**40ACV-PB3-04N3**  
LinkTech 40AC Series Panel Mt. Male  
Valved, 1/4" HB  
NSF 51 Acetal, NSF 61 Buna-N



**40ACV-PB4-04N3**  
LinkTech 40AC Series Elbow Male  
Valved, 1/4" HB  
NSF 51 Acetal, NSF 61 Buna-N



**40ACV-SB2-04N3**  
LinkTech 40AC Series Straight Female  
Valved, 1/4" HB  
NSF 51 Acetal, NSF 61 Buna-N

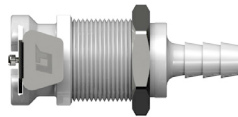

**40ACV-SB3-04N3**  
LinkTech 40AC Series Panel Mt. Female  
Valved, 1/4" HB  
NSF 51 Acetal, NSF 61 Buna-N



**40ACV-SB17-04N3**  
LinkTech 40AC Series Inline Socket  
Valved, 1/4" HB  
NSF 51 Acetal, NSF 61 Buna-N



**40CB-PB4-04N3**  
LinkTech 40CB Series Elbow Plug  
Non-valved, 1/4" HB  
Chrome Brass, NSF 61 Buna-N



**40CBV-PB1-04N3**  
LinkTech 40CB Series Male Thread Male  
Valved, 1/4" MNPT  
Chrome Brass, NSF 61 Buna-N

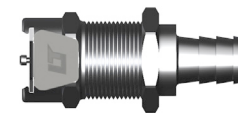

**40CBV-SB3-06N3**  
LinkTech 40CB Series Panel Mt. Socket  
Valved, 3/8" HB  
Chrome Brass, NSF 61 Buna-N



**40CBV-SB9-06N3**  
LinkTech 40CB Series Inline Socket  
Valved, 3/8" PTF  
NSF 51 Acetal, NSF 61 Buna-N



# NSF/ANSI 169-Certified

## QUICK CONNECTS

### 50 SERIES QUICK CONNECT COUPLINGS

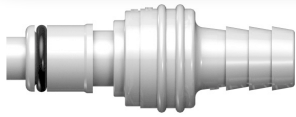

#### 50ACV-PE2-06N3

LinkTech 50AC Series Inline Plug Valve  
Valved, 3/8" HB  
NSF 51 Acetal, NSF 61 EPDM



#### 50ACV-SB2-06N3

LinkTech 50AC Series Straight Female  
Valved, 3/8" HB  
NSF 51 Acetal, NSF 61 Buna-N

### 60 SERIES QUICK CONNECT COUPLINGS

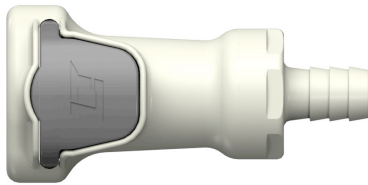

#### 60PP-S2-06N3

LinkTech 60PP Series Inline Socket  
Non-Valved, 3/8" HB  
Polypropylene

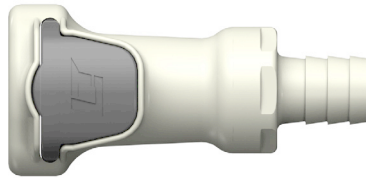

#### 60PPV-SE2-08N3

LinkTech 60PP Series Straight Female  
Valved, 1/2" HB  
Polypropylene, NSF 61 EPDM

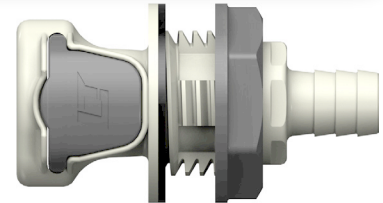

#### 60PPV-SE3-08N3

LinkTech 60PP Series Panel Mt. Female  
Valved, 1/2" HB  
Polypropylene, NSF 61 EPDM

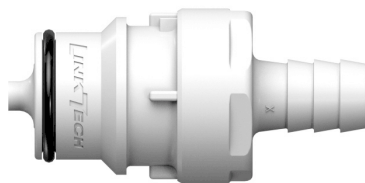

#### 60PSV-PE2-06N3

LinkTech 60PS Series Inline Plug  
Valved, 3/8" HB  
Polysulfone, NSF 61 EPDM



#### 60PSV-SE2-06N3

LinkTech 60PS Series Straight Female  
Valved, 3/8" HB  
Polysulfone, NSF 61 EPDM