

INSTALLATION INSTRUCTIONS

POINT-OF-USE AIR-GAP FOR REVERSE OSMOSIS (RO) WATER TREATMENT SYSTEMS

Sink Mounted AIRGAP™ – Model 3002

SPECIFICATIONS

Location:	On the sink skirt.
Hole:	1" minimum diameter, located at least 7/8" from the edge.
Air Gap:	1" of free flow.
Water Flow:	0.5 gallons per minute maximum.
Inlet Tubing:	1/4" O.D. polyethylene.
Outlet Tubing:	3/8" O.D. polyethylene.
Cutting Tool:	Chassis Punch (Stainless Steel) Porcelain Cutter (Porcelain/Enamel/Tile)

INSTALLATION INSTRUCTIONS

Important: Sink surface may be damaged if the wrong tools or procedure is used for drilling hole.

1. Select location on sink for installing AIRGAP™. Use or enlarge an existing hole if possible. Otherwise drill a new hole per Specifications.

Note: Location must provide sufficient space to route the tubing without sharp turns. Sharp turns tend to flex and deform the tubing, reducing its flow capacity.

Item callouts refer to Figure 2

2. Center the base (Item 1) on the hole and secure it with the clamp (Item 2).
3. Install tubes onto AIRGAP™ body (Item 3).
 - a. Insert the tubes through the base from under the counter, the 1/4" tube (Item 4) through the small hole and the 3/8" tube (Item 5) through the large one, until there is approximately 15" of tubing is above the base.

Caution: Do not use boiling water in this procedure. Use hot water from the sink faucet only.

- b. Soak one end of each tube in hot water until the plastic becomes pliant.

- c. Push the 1/4" tube (Item 4) all the way onto the small barb. Push the 3/8" tube (Item 5) all the way onto the large barb.

4. Push the AIRGAP™ (Item 3), with tubes installed, into the base (Item 1) until outlet rests on support.
5. Install the cover (Item 6). Align the groove with the outlet and press the cover firmly onto the base.
6. Connect the 1/4" tube (Item 4) to the system and the 3/8" tube (Item 5) to the drain.

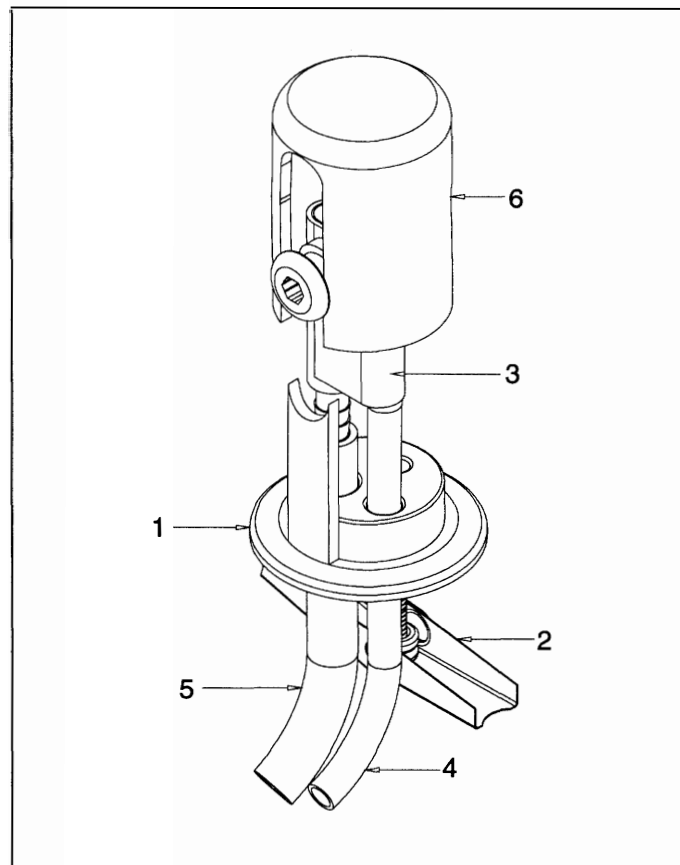

Figure 2: Component Locator, Sink-Mounted Air Gap