

PENTEK DURA-SERIES™

WATER FILTER

INSTALLATION AND OPERATING INSTRUCTIONS

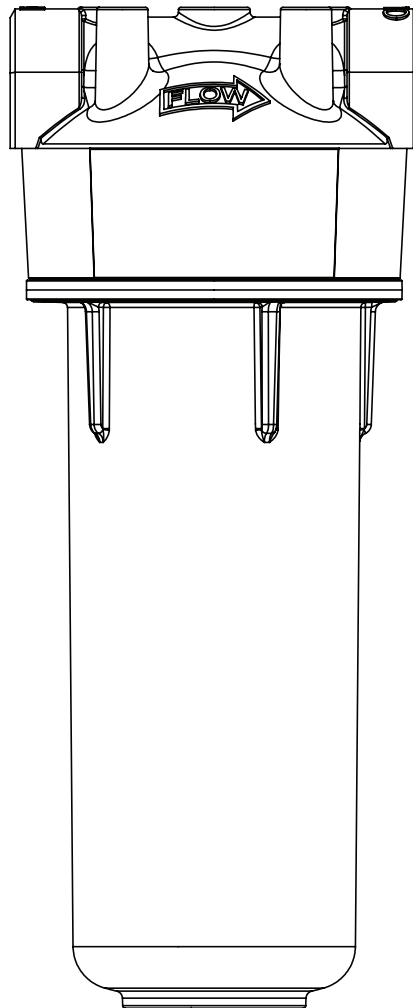

TABLE OF CONTENTS

Specifications	3
Tools Required	3
Materials Required.....	3
Precautions	3
Whole House Installation	4
Undersink Installation.....	5
Cartridge Replacement	5
Troubleshooting.....	6
Replacement Filter Cartridges	7

SPECIFICATIONS

Filter Housing	Temperature Range	Pressure Range
3/4-inch I/O	40-125°F (4.4-51.7°C)	30-125 psi (2.1-8.62 bar)

California Residents - Proposition 65

⚠ WARNING: This product contains chemicals known to the State of California to cause cancer or birth defects or other reproductive harm.

TOOLS REQUIRED

- Screwdriver
- 2 Adjustable Wrenches
- File
- Pencil
- Pipe Cutter or Hacksaw

MATERIALS REQUIRED

Depends on type, size, and location of pipe on which system will be installed. See instructions that relate to your particular installation, or consult your local hardware store or plumbing supplier to find out more about your particular installation needs.

PRECAUTIONS

⚠ WARNING: Do not use with water that is microbiologically unsafe or of unknown quality without adequate disinfection before or after the system.

CAUTION: Filter must be protected against freezing, which can cause cracking of the filter and water leakage.

CAUTION: The rubber O-ring provides the watertight seal between the cap and the bottom of the housing. It is important that the O-ring be properly seated in the groove above the threads of the housing, or a water leak could occur.

CAUTION: To prevent costly repairs or possible water damage, the sump of plastic housings must be replaced every five (5) years for clear, and 10 years for opaque. If sump is older than recommended, replace immediately. Date sump for reference and indicate replacement date.

- Install on cold water line only.
- Do not install where system will be exposed to direct sunlight.
- Make certain that installation complies with all state and local laws and regulations.
- For prolonged periods of non-use (such as during a vacation), it is recommended that the system be flushed thoroughly. Let water run for 5-6 minutes before using.
- The filter cartridge has a limited service life. A decrease in water flow indicates that the cartridge should be replaced.
- If your cartridge seems to disintegrate or has a musty or moldy odor, switch to a synthetic media cartridge or consult the cartridge manufacturer.

WHOLE HOUSE INSTALLATION

(3/4-inch main cold water line)

Materials Required:

- (2) 3/4-inch NPT compression fittings
- Plumber's tape
- Reducing adapters (if necessary)

Note:

- Reducing adapters can be used to adapt the filter to different pipe sizes. See your local hardware store or plumbing store for help in selecting the necessary adapters and compression fittings for your installation needs.
 - Galvanized fittings must be used with installation on galvanized pipe.
 - Filter must be installed after water meter or pressure tank.
1. Turn off cold water supply and open nearest faucet to drain pipes before starting installation. Wrap about 6" of plumber's tape in clockwise direction around pipe threads of each compression fitting.
 2. If mounting bracket (not supplied) is to be used, first use bracket as a template to mark screw locations. Then place bracket over cap and align with inlet and outlet ports. Allow 2 1/4" clearance below housing to enable cartridge changes.
 3. Start compression fittings into cap by hand and use a wrench to tighten firmly. **DO NOT OVERTIGHTEN.** Remove compression nuts from fittings.
 4. Measure length (shown as X on Figure 4) across assembled fittings and subtract 1" if you are installing on 3/4" pipe or 1-1/2" if you are installing on 1/2" pipe. Mark section of pipe to be removed.
 5. Using a pipe cutter or hacksaw, cut pipe and remove marked section of pipe. File or sand sharp edges on remaining pipe.
 6. Slip compression nut and ferrule onto each end of pipe.
 7. Align filter assembly with ends of pipe, making certain cap opening marked "IN" is facing your incoming water supply. It will be necessary to spread ends of pipe apart to install filter assembly. Using two (2) adjustable wrenches, hold incoming adapter securely with one wrench and tighten nut with second wrench. Repeat process for outgoing adapter.
 8. Slowly turn on the water supply to allow filter to fill with water, then press the red pressure-relief button on top of filter to release trapped air. Open nearest faucet and flush water through cartridge for five (5) minutes. Check for leaks before leaving installation.
 9. **CAUTION:** If water pipes are used to ground electrical systems, appliances, or phones, be certain to install a jumper wire. Contact a qualified electrician with any questions about your home's electrical system.

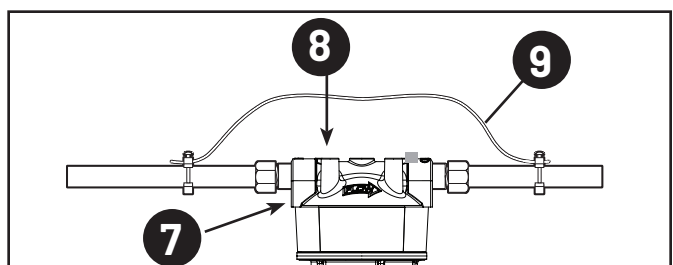
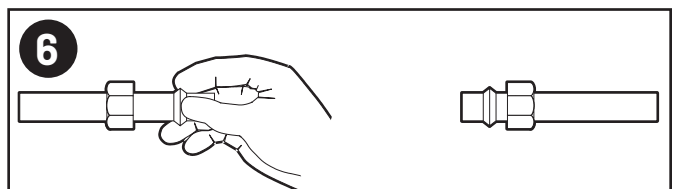
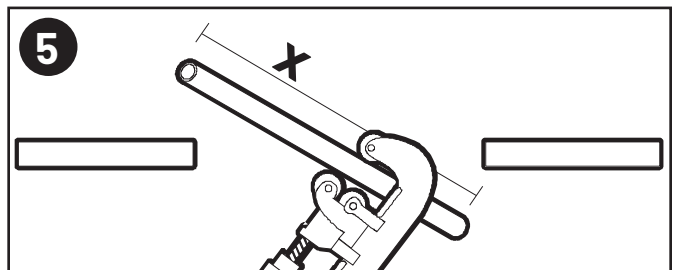
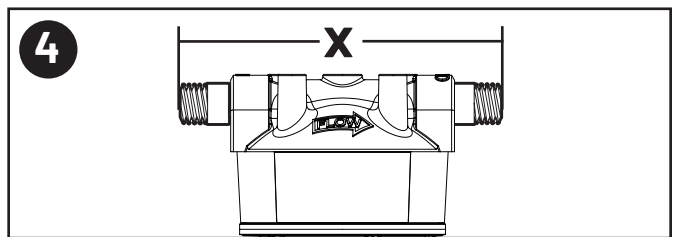
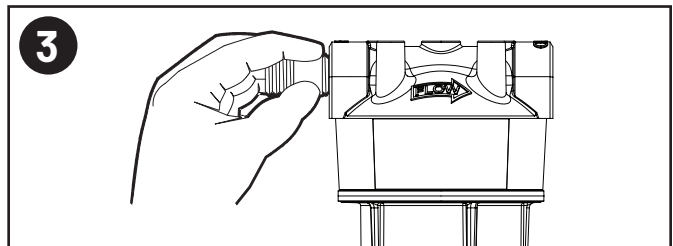
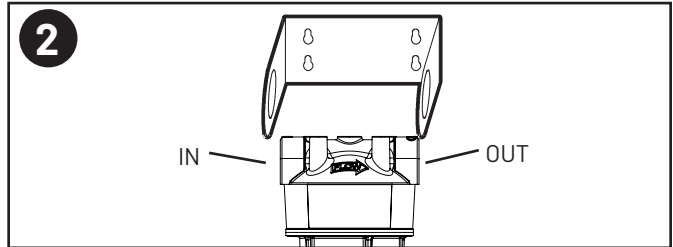
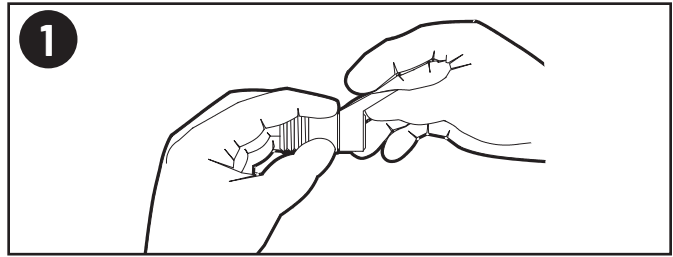

UNDERSINK INSTALLATION

(3/8-inch cold water line)

Materials Required:

- Plumber's tape
- Plastic tubing
- (2) 3/8" compression fittings
- (2) 3/8" compression elbows (with ferrules and tubing inserts)
- (2) 3/8" to 3/4" NPT reducing adapters (for installation of 3/4" I/Os / filters)

Note: Reducing adapters can be used to adapt the filter to different pipe sizes. See your local hardware store or plumbing store for help in selecting the necessary adapters and compression fittings for your installation needs.

1. Turn off cold water supply and open nearest faucet to drain pipes before starting installation. Place a tray or towel under the cold water line to catch excess water. Wrap about 6" of plumber's tape in clockwise direction around pipe threads of each fitting/adaptor.
2. Attach the mounting bracket: See #2 under Whole House Installation or use the self-tapping screws, attach mounting bracket to cap. Mark location under sink where filter is to be mounted. Allow 2 1/4 inches under filter to enable cartridge changes.
3. Assemble fittings/adapters. Start fitting/adaptor into inlet of cap by hand, then tighten with a wrench. **DO NOT OVERTIGHTEN.** Repeat for outlet on filter cap.
4. Using a pipe cutter or hacksaw, remove a 3" section of pipe from the cold water line. Deburr ends of remaining pipe with a file.
5. Determine the lengths of tubing needed to connect the inlet and outlet sides of the filter to compression elbows on the cold water line. Measure tubing short enough to prevent kinking. Using two wrenches, tighten compression nuts 1-1/2 to 2 turns.
6. Turn on water supply to allow filter to slowly fill with water, then press the pressure-relief button on the housing to release trapped air. Open faucet and flush filter with water for five (5) minutes. Check for leaks and tighten fittings as needed.

CARTRIDGE REPLACEMENT

- A. Turn off water supply to filter. Depress red pressure-relief button to relieve the pressure, then twist off bottom of housing.

Note: If turning off water supply to filter will also turn off water supply to the rest of the home, be sure to fill a bucket of water first to allow you to clean the housing after it has been removed.

- B. Locate and remove large O-ring, wipe clean of lubricant, and set aside. Discard used cartridge. Rinse out bottom of housing and fill about 1/3 full with water. Add about one (1) tablespoon of bleach and scrub cap and bottom of housing with nonabrasive sponge or cloth. Rinse thoroughly. Lubricate O-ring with clean silicone grease. Clean groove and connection point on cap. Insert O-ring back into groove and smooth into place with finger. Insert new cartridge over standpipe in bottom of housing.
- C. Wrench may be used to install sump, **DO NOT OVERTIGHTEN.** When sump engages against cap, sump is fully installed. Make certain cap standpipe slips into cartridge. Slowly turn on the water supply to allow filter to fill with water and then press the red pressure-relief button on top of the filter to release trapped air. Open faucet and flush filter with water for five (5) minutes. Check for leaks before leaving installation.

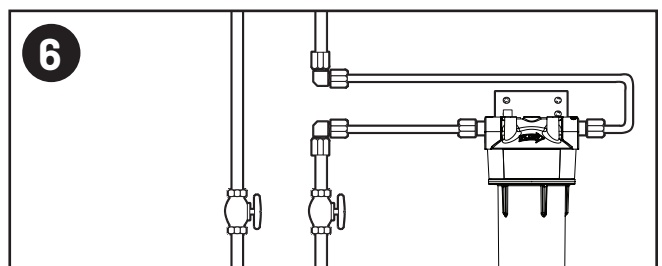
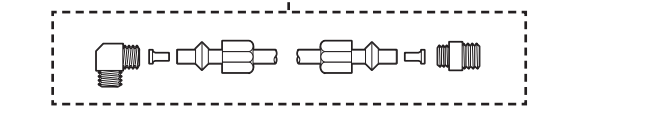
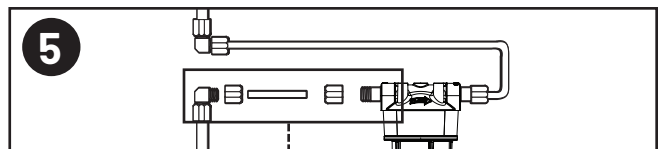
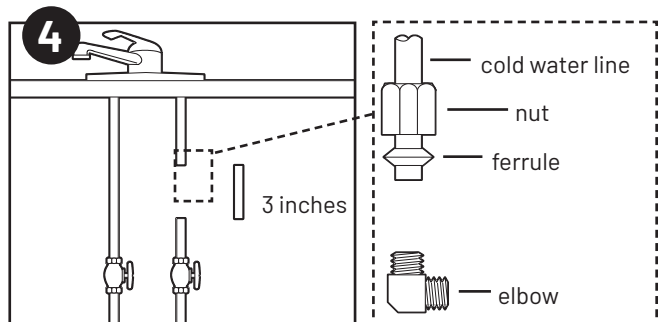
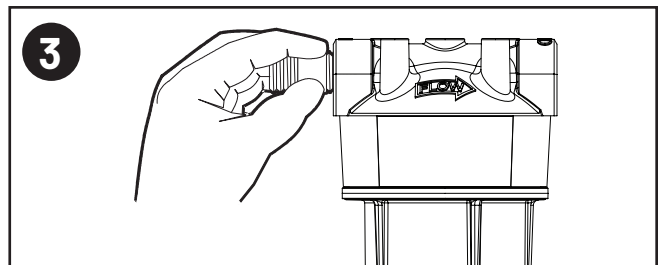
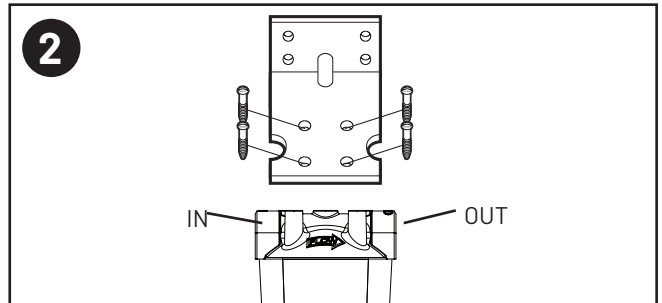
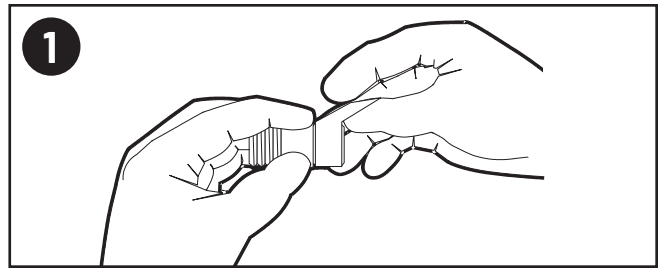

TROUBLESHOOTING

Leaks...

Between cap and bottom of housing:

1. Turn off water supply and press the red pressure-relief button.
2. Clean and lubricate O-ring if necessary. Wrench may be used to install sump, **DO NOT OVERTIGHTEN**. When sump engages against cap, sump is fully installed.

On unit inlet/outlet connections:

1. Turn off water supply. Tighten compression fittings with a wrench. **DO NOT OVERTIGHTEN**.
2. Turn on water supply. If leaks persist, or if there are other leaks on unit, turn off water supply. Call Pentair Technical Support at 1-800-279-9404.

REPLACEMENT FILTER CARTRIDGES

WHOLE HOUSE SEDIMENT CARTRIDGES

Model	Filtration Rating	Filter Material/ Construction	Max Flow Rate/ Pressure Drop	Filter Life*	Reduces:				
					Scale & Rust Particles	Coarse Sand	Sand, Dirt, Silt	Fine Sand, Dirt, Silt	Extra-Fine Sand, Dirt, Silt
P5	5 micron nom.	Spun Polypropylene	10 gpm/<1 psi	2 mo.	•	•	•	•	•
CP-5	5 micron nom.	Pleated Cellulose/Poly	10 gpm/<1psi	2 mo.	•	•	•	•	•
CW-F	10 micron nom.	Cord-Wound	7 gpm/< 1 psi	3 mo.	•	•	•	•	
S1	20 micron nom.	Pleated Cellulose	10 gpm/< 1 psi	4 mo.	•	•	•		
CW-MF	30 micron nom.	Cord-Wound	10 gpm/< 1 psi	3 mo.	•	•	•		
R30	30 micron nom.	Pleated Polyester	12 gpm/< 1 psi	4 mo.	•	•	•		
R50	50 micron nom.	Pleated Polyester	12 gpm/< 1 psi	4 mo.	•	•			

UNDERSINK DRINKING WATER CARTRIDGES

Model	Filtration Rating	Filter Material/ Construction	Max Flow Rate/ Pressure Drop	Filter Life*	Reduces:		
					Chlorine Taste & Odor	Bad Taste	Sediment
C1	5 micron nom.	Carbon-Impregnated Cellulose	5 gpm/2 psi	3 mo.	•	•	•
CC-10	—	Granular Activated Carbon (coconut-shell)	1 gpm/3 psi	6 mo.	•	•	
GAC-10	—	Granular Activated Carbon	1 gpm/3 psi	6 mo.	•	•	
CBC®-10	0.5 micron nom.	Activated Carbon Block	1 gpm/< 2 psi	12 mo.	•	•	•

* Filter cartridge life varies depending on filter type, usage, and water conditions.

For Pentair Product Warranties visit: } pentair.com/assets/residential-filtration-warranty



13845 Bishops Dr. | Suite 200 | Brookfield, WI 53005 | United States
P: 262.238.4400 | Customer Service: 800.279.9404 | tech-support@pentair.com | pentair.com

All indicated Pentair trademarks and logos are property of Pentair. Third party registered and unregistered trademarks and logos are the property of their respective owners.

©2024 Pentair. All Rights Reserved.

248332 REV C MY24