

# F-NT Type - 1.0 to 26.5 L/min

## Flow Regulator - Pressure Compensating



flow, stop and go®

### Features and Benefits

- ▶ Operates as a flexible orifice to provide reliable flow regulation from 15 to 150 psi.
- ▶ Noiseless and trouble free operation over many years.
- ▶ Press-fit design helps meet 8 lb pull-out force requirement.
- ▶ Select flow rates help with WaterSense requirements for faucets or showers.

### Options Available

Part #	Color	gpm	L/min
58.7351.1	White / Pink	0.26	1.0
58.7352.1	White / Olive green	0.53	2.0
58.7353.1	White / Brown	0.79	3.0
58.7354.1	White / Gray	1.06	4.0
58.7355.1	White / Yellow	1.32	5.0
58.7356.1	White / Black	1.59	6.0
58.7357.1	White / Green	1.85	7.0
58.7358.1	White / White	2.11	8.0
58.7359.1	White / Orange	2.38	9.0
58.7360.1	White / Blue	2.64	10.0
58.7361.1	White / Brown	2.91	11.0
58.7362.1	White / Red	3.17	12.0
58.7363.1	White / Olive green	3.43	13.0
58.7364.1	White / Pink	3.70	14.0
58.7365.1	White / Lime green	3.96	15.0
58.7366.1	White / Dark blue	4.23	16.0
58.7370.1	White / Green	5.28	20.0
58.7349.1	White / Lilac	5.81	22.0
58.7350.1	White / Red	7.00	26.5

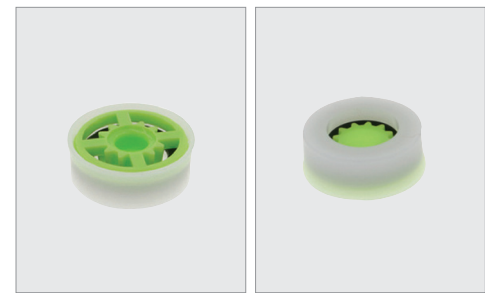

### Certification

ANSI / NSF 61

### Materials

Name	Material
Body	Acetal
Core	Acetal
O-ring	EPDM

### Technical Data

Medium: Clear water only

Wetted surface area: 1373.29 mm<sup>2</sup>

Continuous

Short-term (5 minutes max.)

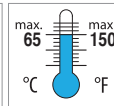
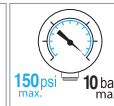
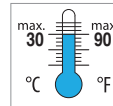

### Dimensions

#### Flow Regulator Dimensions

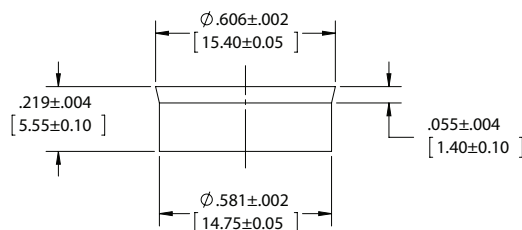

#### Mounting Dimensions

