

Fresh Water Systems Filter Housing Installation Kits: Includes bracket, screws or lags, male adapters, close nipple (dual and triple only) Teflon tape and a wrench

Single:

Attach an appropriate housing cap* to the bracket so that your plumbing water flow matches the in and out of the cap. The pressure release button (if equipped) is on the inlet side.

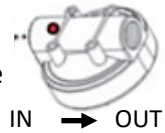

Attach the bracket to the wall location after the cap has been secured to it. Once on the wall and plumbing connections are complete load the filter cartridge into a housing sump and screw the sump to the cap. Turn water back on slowly and check for leaks.

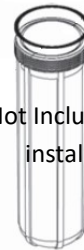
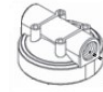
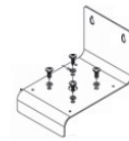

* Not Included with install kit

Dual:

Connect the caps* together using the close nipple and Teflon tape. Attach the caps to the bracket so that your plumbing water flow direction matches the in and out of the cap. The pressure release button (if equipped) is on the inlet side of the second housing.

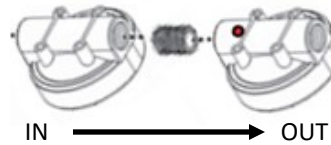

Attach the bracket to the wall location after the caps have been secured to it. Once on the wall and plumbing connections are complete load the filter cartridges into the sumps* and screw them to the caps. Turn water back on slowly and check for leaks.

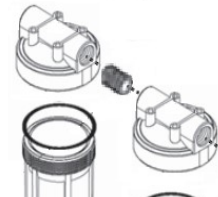
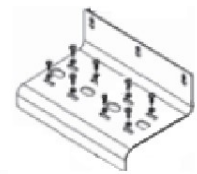

* Not Included with install kit

Triple:

Connect the caps* together using the close nipples* and Teflon tape. Attach the caps to the bracket so that your plumbing water flow direction matches the in and out of the caps. The pressure release button (if equipped) is on the inlet side of the third and last housing.



Attach the bracket to the wall location after the caps have been secured to it. Once on the wall and plumbing connections are complete load the filter cartridges into the sumps* and screw them to the caps. Turn water back on slowly and check for leaks.

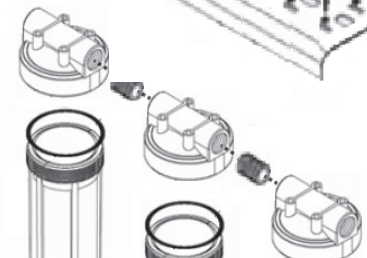
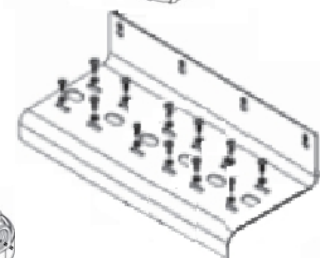

* Not Included with install kit