

Two Way Divider

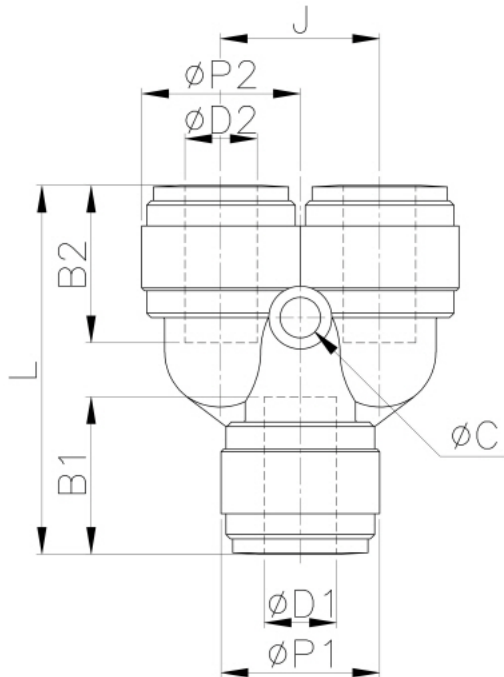

Pressure Ratings			
	< 5/16"	3/8"	1/2"
33 °F	290 psi	232 psi	203 psi
68 °F	290 psi	232 psi	203 psi
150 °F	232 psi	203 psi	116 psi

Model	$\varnothing D1$	$\varnothing D2$	B1	B2	$\varnothing P1$	$\varnothing P2$	L	J	$\varnothing C$	WEIGHT(g)
ATWD44M	04	04	14.7	14.7	13.8	13.8	33.7	13.5	3.3	6.7
ATWD66M	06	06	16.1	16.1	15.5	15.5	38.8	15.5	3.3	9.2
ATWD88M	08	08	17.5	17.5	17.6	17.6	41	17.6	4.5	11.6
ATWD108M	10	08	20.1	17.5	20	20	45.9	20	4.5	16.8
ATWD1010M	10	10	20.1	20.1	20	20	46.2	20	4.5	16
ATWD1212M	12	12	24.7	24.7	23	23	56.4	23	4.5	26.3